

109

ev.k.sampath road.
[RUNDALS ROAD] TO EGMORE STATION

Planning Permit No. C/PP/64/A/8
APPROVED
SUBJECT TO THE CONDITIONS IN THIS OFFICE LETTER.
No. C/4840/193 Dated 7.9.93
FOR MEMBER SECRETARY
MADRAS METROPOLITAN
DEVELOPMENT AUTHORITY
MADRAS - 600 008.

AREA DETAILS

R. Rajan
dt. 28/1/93

I. OWN LAND	
1) R.S. NO. 682	→ 2 CAW II GRs 1326 SQ. FT. = 59 GRs 132.6 SQ. FT. = 13278.27 SQ. MT.
2) R.S. NO. 681	→ 13 GRs 771 SQ. FT. = 13 GRs 771 SQ. FT. = 2970.21 SQ. MT.
TOTAL	72 GRs 2097 SQ. FT. = 16248.48 SQ. MT.
II. LEASED LAND	
1) R.S. NO. 667 (OS-34)	→ 2 AC 78 CENT 181 SQ. FT. = 50 GRs 1278 SQ. FT. = 11267.11 SQ. MT.
2) R.S. NO. 665/2 (OS-32 + 18)	→ 2 CAW III GRs 2333-61 GRs 2333 SQ. FT. = 13817.76 SQ. MT.
3) R.S. NO. 665/1	→ 8 GRs 67 SQ. FT. = 8 GRs 67 SQ. FT. = 4759.36 SQ. MT.
TOTAL	120 GRs 1272 SQ. FT. = 26877.85 SQ. MT.
GRAND TOTAL	193 GRs 3369 SQ. FT. = 43126.33 SQ. MT.

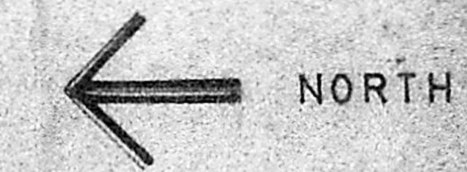

REFERENCE

PROPOSED WORK	-
BOUNDARY LINE	-
ROADS	-
DUST BINS	-

THE ASSOCIATION OF ST. CHRISTOPHER'S COLLEGE OF EDUCATION 63 TO 66 EV.K.SAMPATH ROAD, VEPERY, MADRAS.7.
DIV. NO:

SITE PLAN
SCALE 1/66 INCH TO A FOOT OR 1:800

P. Chandrasekhar
Principal
ST. CHRISTOPHER'S COLLEGE OF EDUCATION
VEPERY, MADRAS-600007.

A.C. Rajan
A. C. RAJAN,
LICENSED SURVEYOR
RA 163
MADRAS.
15, Varadarajulu Road,
EGMORE, MADRAS-6

LICENCED SURVEYOR

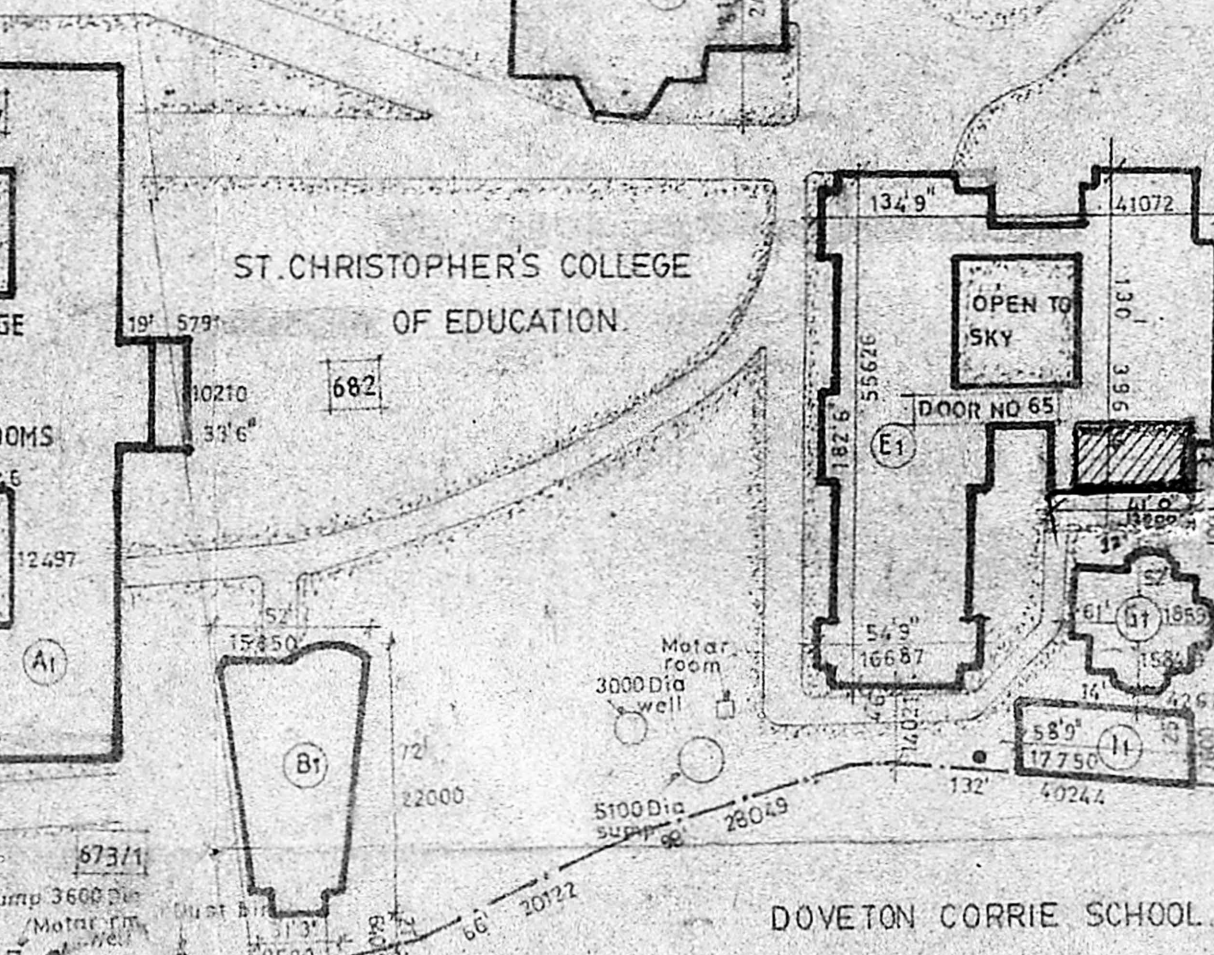
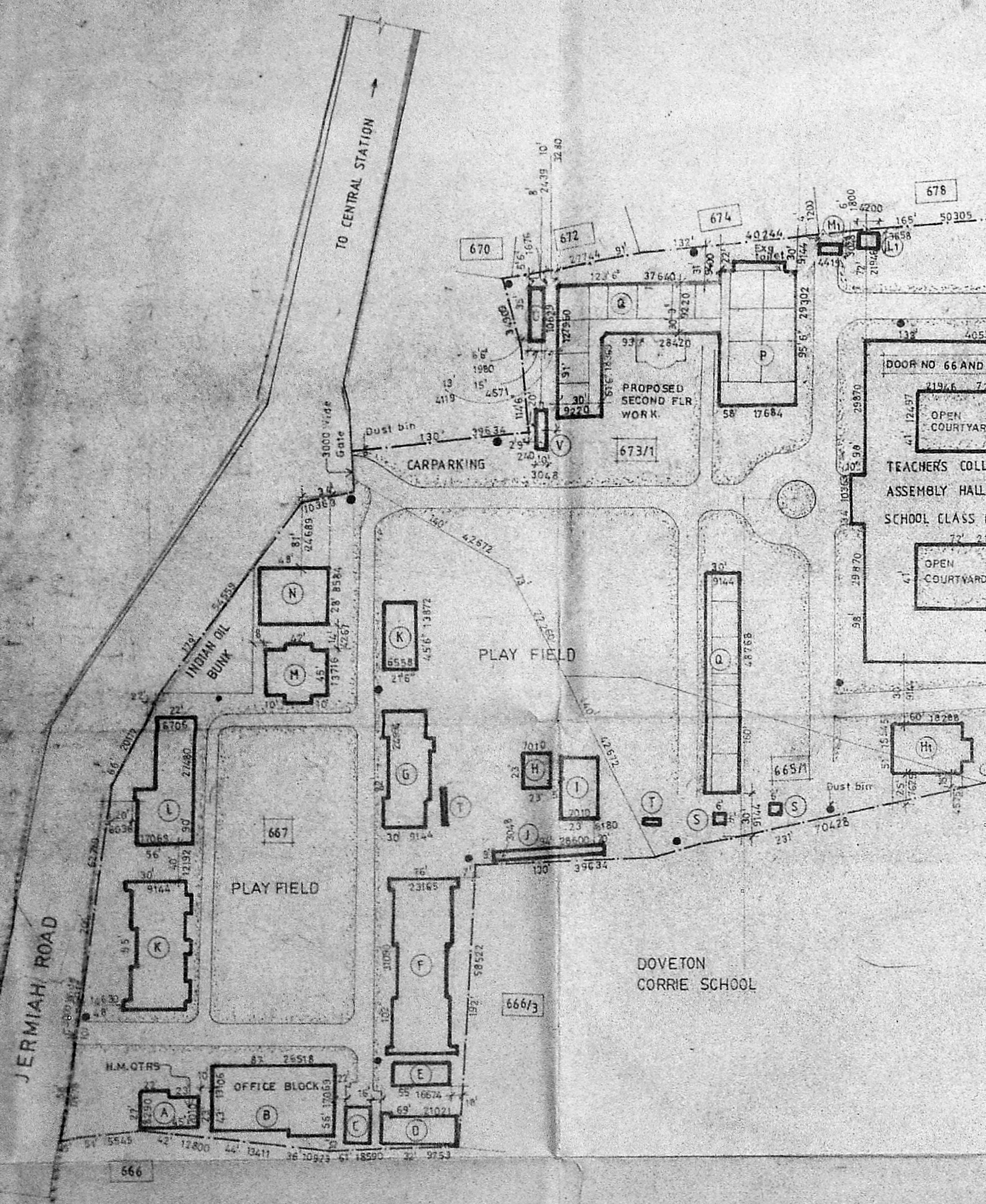

SCHEDULE OF AREAS OF EXISTING APPROVED AND PROPOSED BUILDINGS.

REF. NO.	DESCRIPTION	GROUND FLOOR		FIRST FLOOR		SECOND FLOOR		REMARKS
		SQ. FT.	SQ. M.	SQ. FT.	SQ. M.	SQ. FT.	SQ. M.	
A.	HEADMISTRESS QUARTERS	1100.0	102.38	1100.0	102.30			
B.	OFFICE BLOCK	4520.0	420.00	4338.0	402.90			
C.	MATREN	504.0	46.80					
D.	WATCHMEN	83.6.0	77.00					
E.	GARRAGE	323.0	30.00					
F.	CLASSROOMS	5224.0	477.00	5224.0	477.00			
G.	CLASSROOMS	2680.0	247.20	2680.0	247.20			
H.	CLASSROOMS	529.0	49.20					
I.	GARRAGE	892.0	83.40					
J.	TOILET BLOCK	1043.0	96.90					
K.	HOSTEL BLOCK	5620.0	522.40					
L.	KINDERGARTEN CLASSES	4013.0	373.00					
M.	CHAPEL	1371.0	126.20					
N.	CLASSES	1394.0	129.60					
O.	CLASS ROOMS, LIBRARY ETC.	5559.0	520.00	5559.0	520.00	5559.0	520.00	
P.	HIGHER SECONDARY BLOCK CLASSROOMS AND AUDITORIUM	5782.0	537.00	5782.0	537.00			
Q.	CLASSROOMS (ANNA DREW BLOCK)	4770.0	443.80	4770.0	443.30			
R.	MID DAY MEAL LUNCH SHED	978.0	90.90					
S.	PUMP ROOMS 2 NOS	EACH 36.0	3.35					
T.	DRINKING WATER FACILITIES							
U.	TOILET BLOCK	523.0	48.60					
V.	SEPTIC TANK	300.0	27.82					
A1	OFFICE CUM ASSEMBLY BLOCK	28115.0	2612.91	28115.0	2612.91			
B1	CHAPEL	2782.0	258.55					
C1	NURSERY UNIT	8716.0	810.03	1030.0	95.72			
D1	ACTIVITY ROOM	1000.0	92.93					
E1	(BEDS) HOSTEL-1	14230.0	1322.49	14230.0	1322.49			
F1	BASIC TRAINING HOSTEL-2	7580.0	704.48	3960.0	368.02			
G1	SICK ROOM - BLOCK	1790.0	166.35	1790.0	166.35			
H1	HOME SCIENCE BLOCK	2395.0	222.58					
I1	DRYING UNIT	1470.0	136.61					
J1	SERVANTS QUARTERS	750.0	69.70					
K1	GARAGE	460.0	42.75					
L1	WATCHMAN SHED	168.0	15.51					
M1	WATCHMAN REST ROOM	140.0	13.01					
N1	WATCH AND WARD ROOM	73.0	6.59					
O1	DRIVERS QUARTERS	896.0	84.88					
P1	PRINCIPAL'S QUARTERS	901.0	83.70	654.0	60.76			PRO WORK
Q1	EXTN OF ROOMS IN BED HOSTEL BLOCK							
R1	NURSERY BLOCK PROPOSED							

